

Adjustment

Adjusting the shift cable

1. Set the room side lever and the manual lever (A) to "N" position.

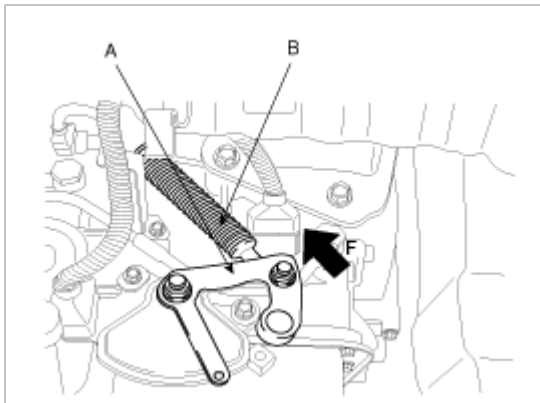

2. Push the shift cable (B) lightly to "F" direction shown to eliminate the free play.

Tightening torque :

10-14Nm (1.0-1.4kgf.m, 7.2-10.1lb-ft)

3. Check that this part operates surely at each range of the manual lever corresponding to each position of the room lever.

Removal

1. Remove the shift lever knob (A).

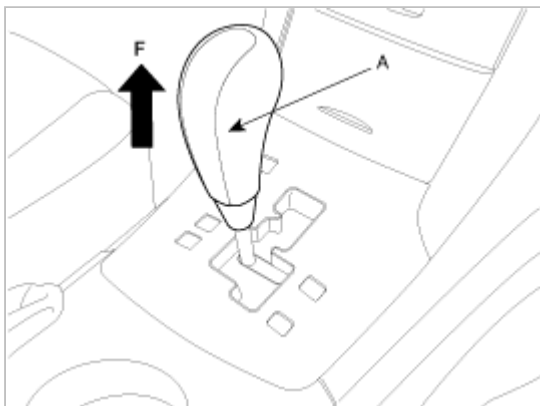

2. Remove the center console cover (A).

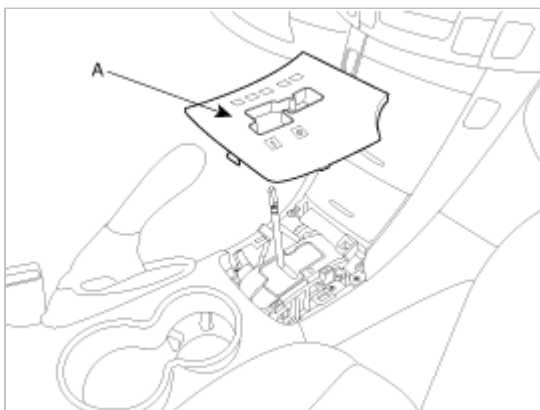

3. Remove the five screw (A) from the center console.



4. Remove the center facia low panel (A).

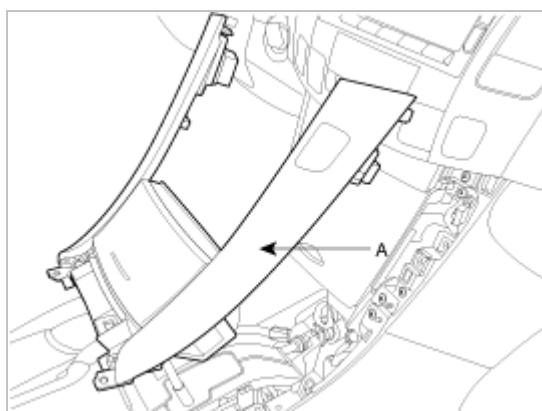

5. Remove the center console. (refer to Console in BD group)

6. Remove the shift cable assembly (A).

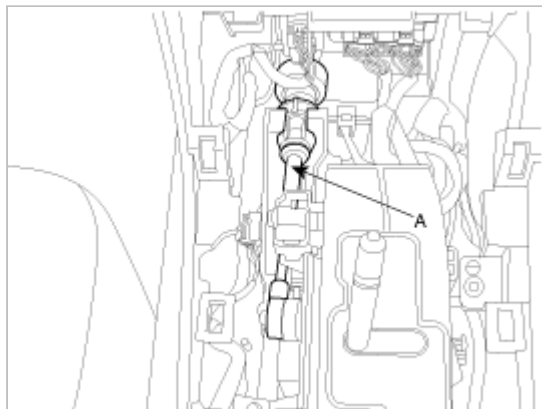

7. Disconnect the sports mode switch connector (A).

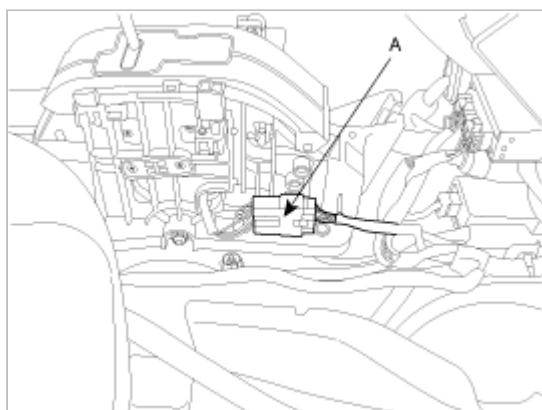

8. Remove the shift lever assembly (A).

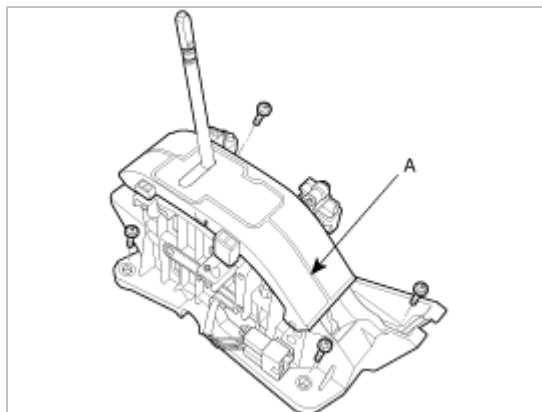

9. Remove the retainer (A) and nuts (B).

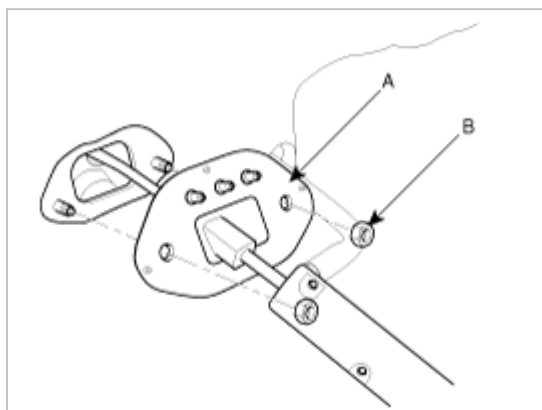

10. Remove the shift cable assembly from the transaxle (refer to Automatic transaxle's removal).

11. Remove the shift cable assembly.

Installation

1. Install the retainer (A) and nuts (B).

Tightening torque :

10-14Nm (1.0-1.4kgf.m, 7.2-10.1lb-ft)

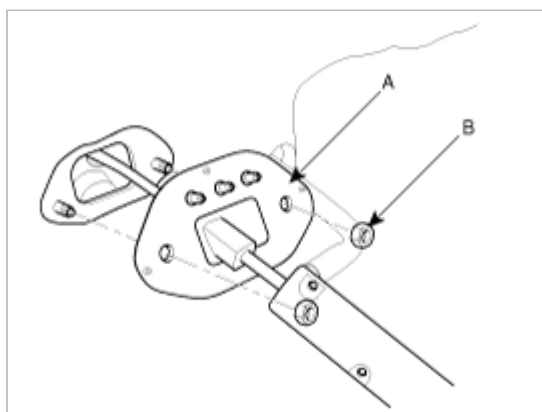

2. Install the shift lever assembly (A).

Tightening torque :

10-14Nm (1.0-1.4kgf.m, 7.2-10.1lb-ft)

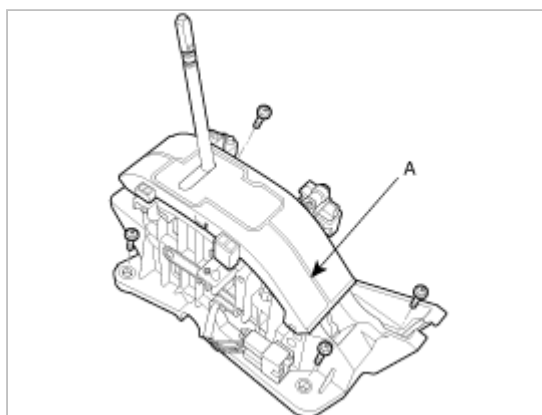

3. Connect the sports mode switch connector (A).

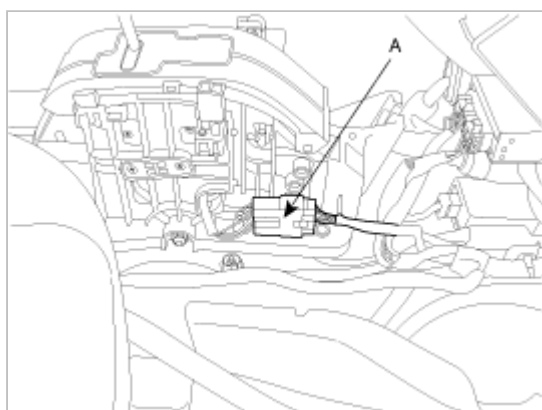

4. Install the shift cable assembly (A).

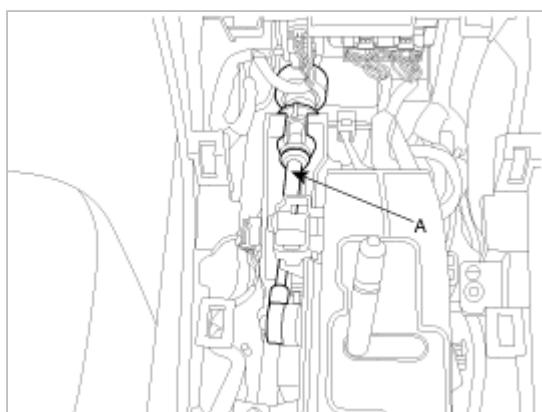

5. Install the center console. (refer to Console in BD group)

6. Install the center facia low panel (A).

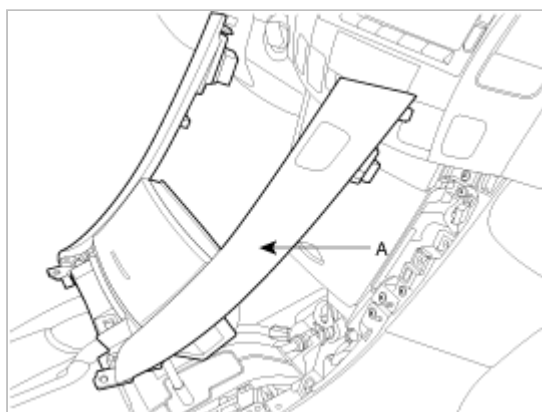

7. Install the five screw (A) to the center console.



8. Install the center console cover (A).

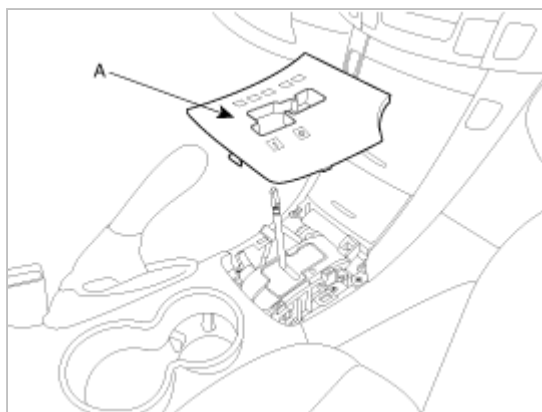

9. Install the shift lever knob (A).

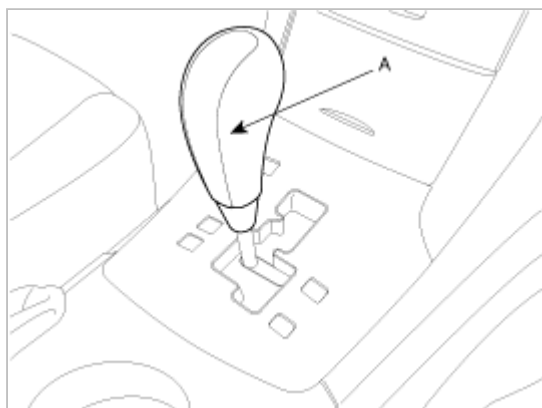

10. Install the shift cable assembly to transaxle. (refer to Automatic transaxle's installation)

NOTE

Before completing installation, adjust the shift cable referring to ADJUSTMENT section.